

Exploded Views and Parts Listing

Indoor Unit Model: BELP008Q3A-D

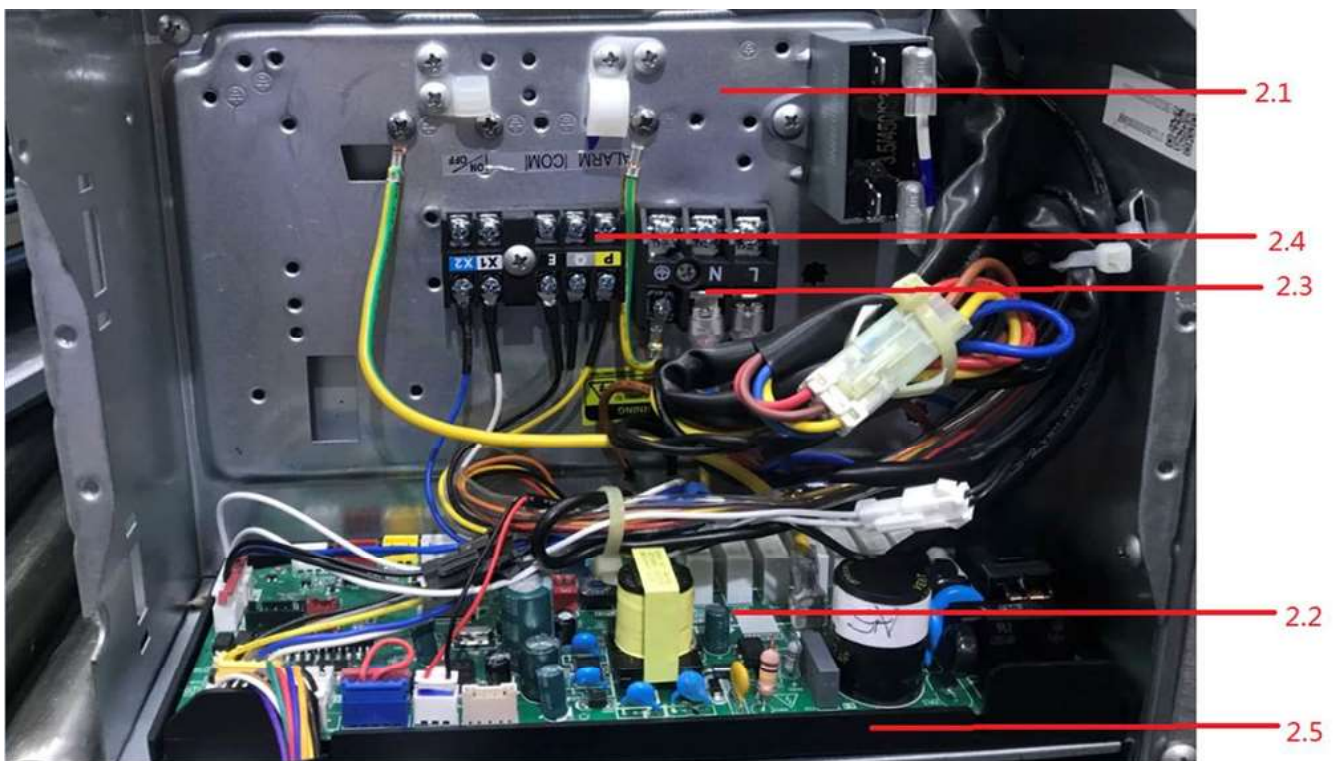
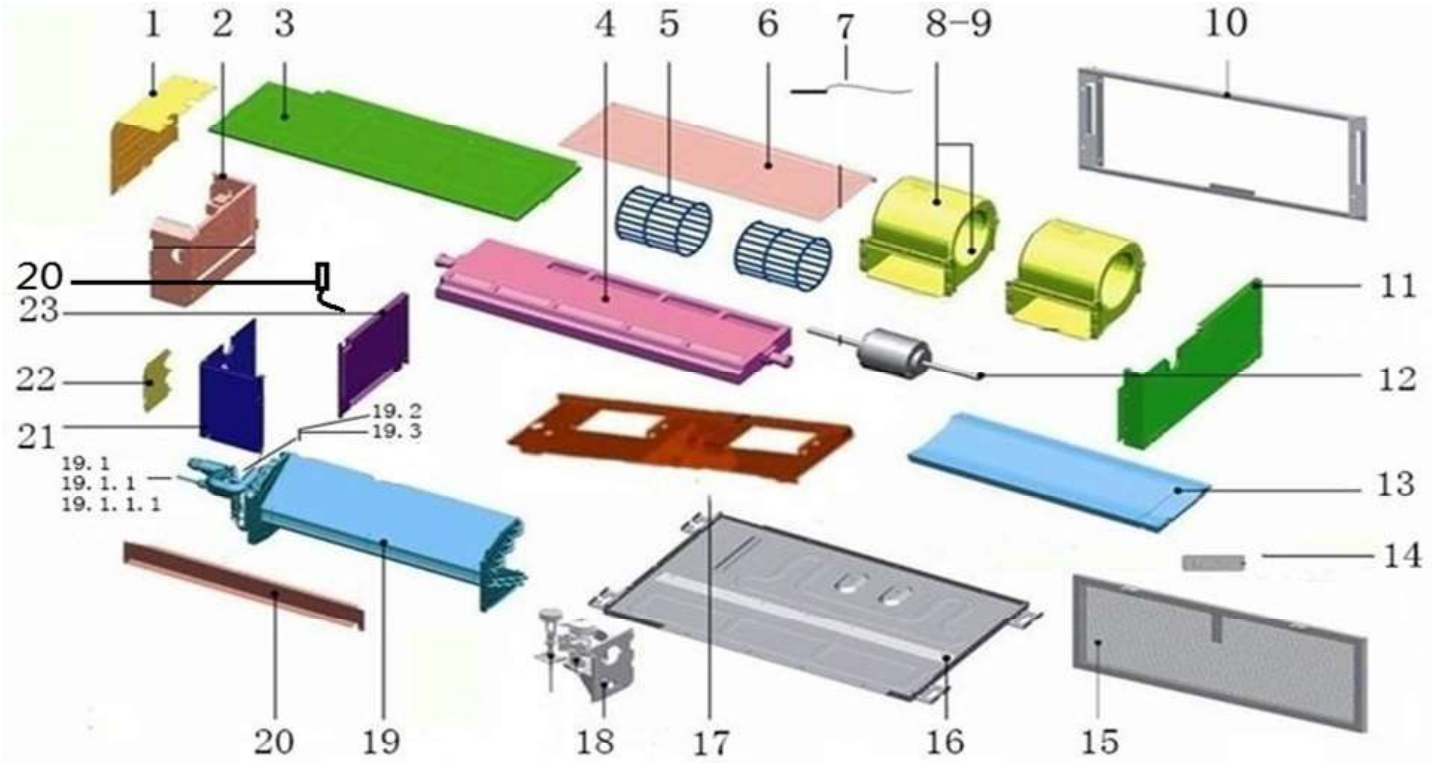

Model: BELP008Q3A-D

No.	Part Name	Part No.
1	Cover of electronic control box subassembly	12223000004387
2	E-part box assembly	17226000004779
2.1	Electronic control box components	12223000003215
2.2	Indoor unit main control board	17126000005254
2.3	Wire joint	17400401000188
2.4	Wire joint	17400401001516
2.5	PCB installation board	12126000002083
3	Top cover assembly	12226000004818
4	Drain pan foam	12823000000024
5	Centrifugal fan	12100103000644
6	Rear cover subassembly	12223000001337
7	Rear cover subassembly	12223000001337
8	top volute	12123000000026
9	volute shell assembly	12126000000061
10	Flange assembly	12223000001510
11	Left clapboard subassembly	12223000001266
12	Single phase asynchronous motor	11002012028044
13	Chassis foam	12823000000021
14	Display board assembly	17223000002836
15	Air filter	12123000000124
16	Base ass	12223000008489
17	Rear beam ass'y	12223000004050
18	Drain pump assembly	17400802000573
19	Evaporator assembly	15826000000452
19.1	Evaporator input pipe assembly	15426000000556
19.1.1	Electronic expansion valve assembly	15426000000557
19.1.1.1	Electronic expansion valve suite	15500213000909
19.2	Evaporator output pipe assembly	15126000002346
19.3	Pipe Temperature Sensor	11201007000070
20	Pipe Temperature Sensor	11201007000030
21	Right clapboard subassembly	12223000001252
22	Pipe clamp board subassembly	12223000008428
23	Right, rear clapboard assembly	12223000001253

Exploded Views and Parts Listing

Indoor Unit Model: BELP010Q3A-D

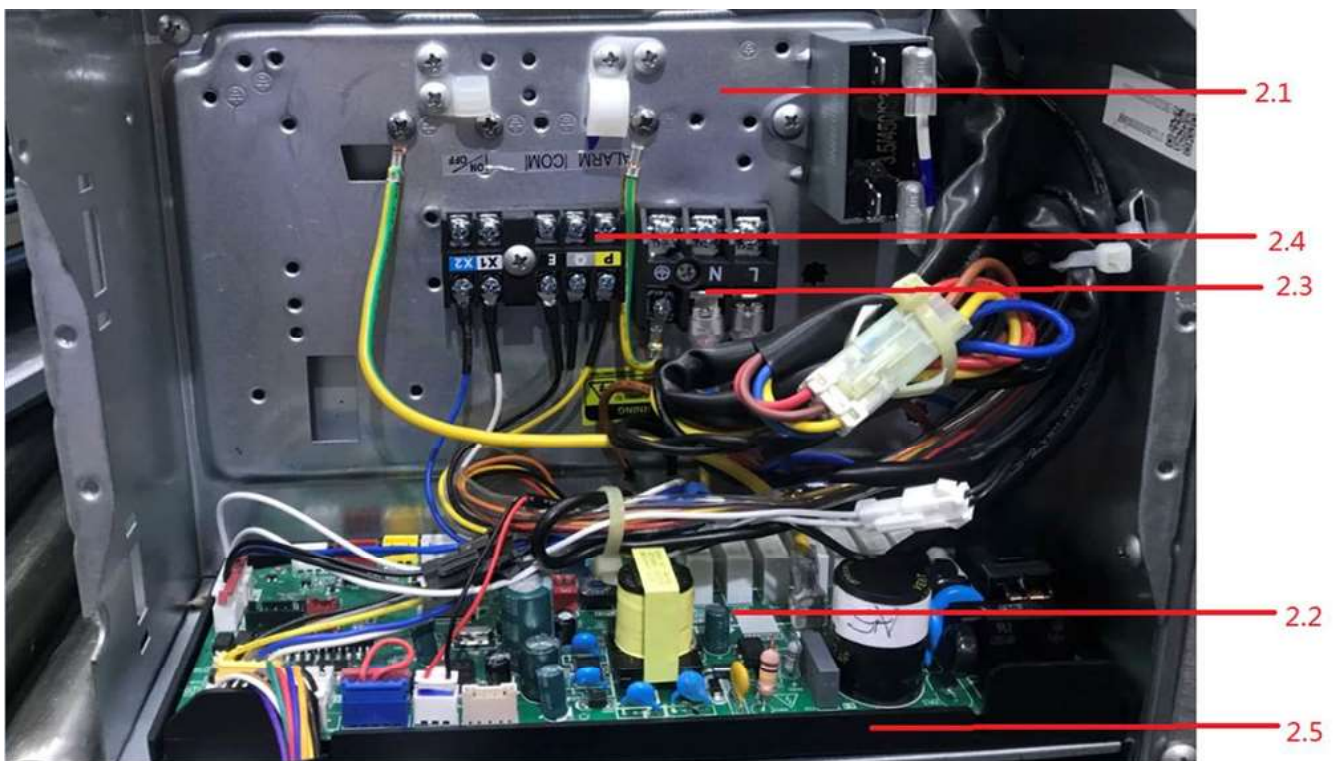
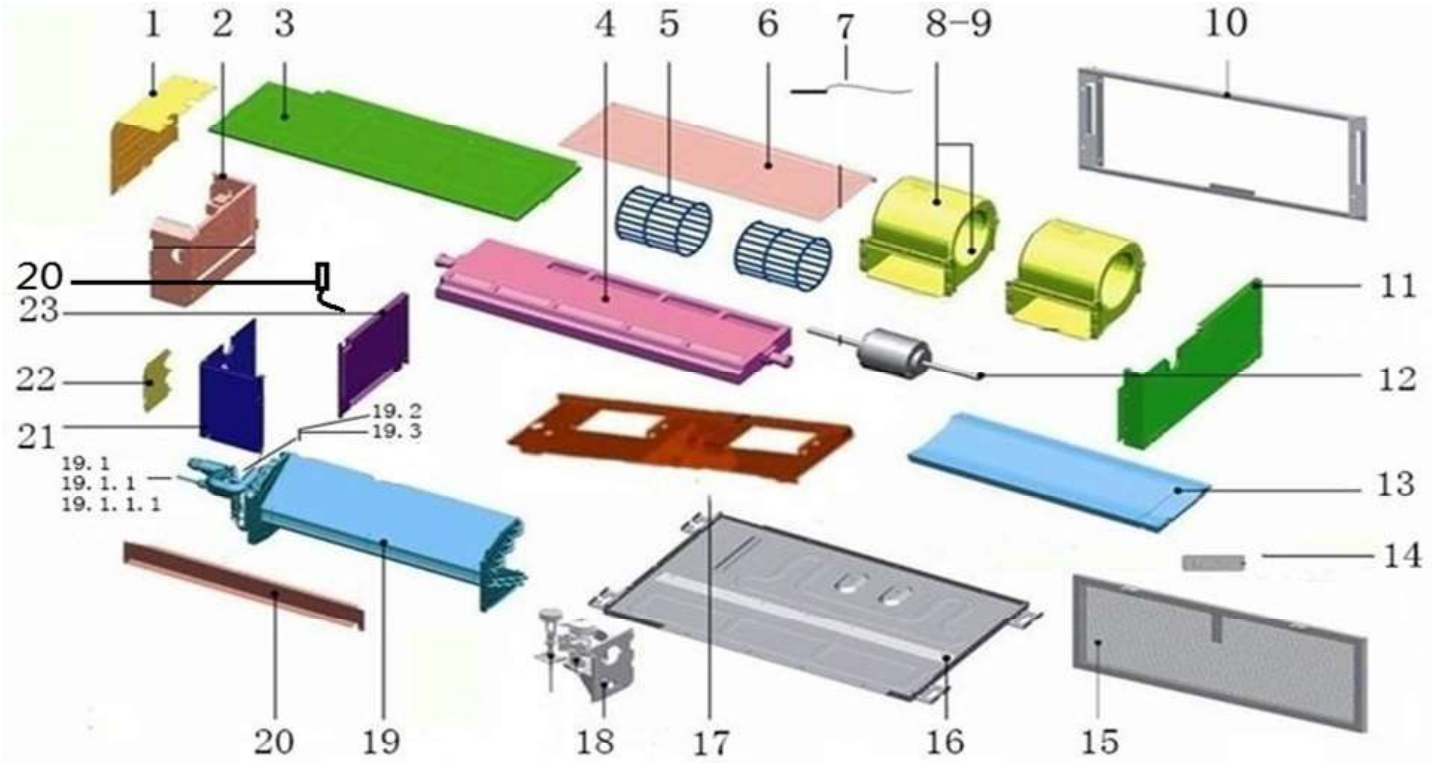

Model: BELP010Q3A-D

No.	Part Name	Part No.
1	Cover of electronic control box subassembly	12223000004387
2	E-part box assembly	17226000004779
2.1	Electronic control box components	12223000003215
2.2	Indoor unit main control board	17126000005254
2.3	Wire joint	17400401000188
2.4	Wire joint	17400401001516
2.5	PCB installation board	12126000002083
3	Top cover assembly	12226000004818
4	Drain pan foam	12823000000024
5	Centrifugal fan	12100103000644
6	Rear cover subassembly	12223000001337
7	Rear cover subassembly	12223000001337
8	top volute	12123000000026
9	volute shell assembly	12126000000061
10	Flange assembly	12223000001510
11	Left clapboard subassembly	12223000001266
12	Single phase asynchronous motor	11002012028044
13	Chassis foam	12823000000021
14	Display board assembly	17223000002836
15	Air filter	12123000000124
16	Base ass	12223000008489
17	Rear beam ass'y	12223000004050
18	Drain pump assembly	17400802000573
19	Evaporator assembly	15826000000452
19.1	Evaporator input pipe assembly	15426000000556
19.1.1	Electronic expansion valve assembly	15426000000557
19.1.1.1	Electronic expansion valve suite	15500213000909
19.2	Evaporator output pipe assembly	15126000002346
19.3	Pipe Temperature Sensor	11201007000070
20	Pipe Temperature Sensor	11201007000030
21	Right clapboard subassembly	12223000001252
22	Pipe clamp board subassembly	12223000008428
23	Right,rear clapboard assembly	12223000001253

Exploded Views and Parts Listing

Indoor Unit Model: BELP012Q3A-D

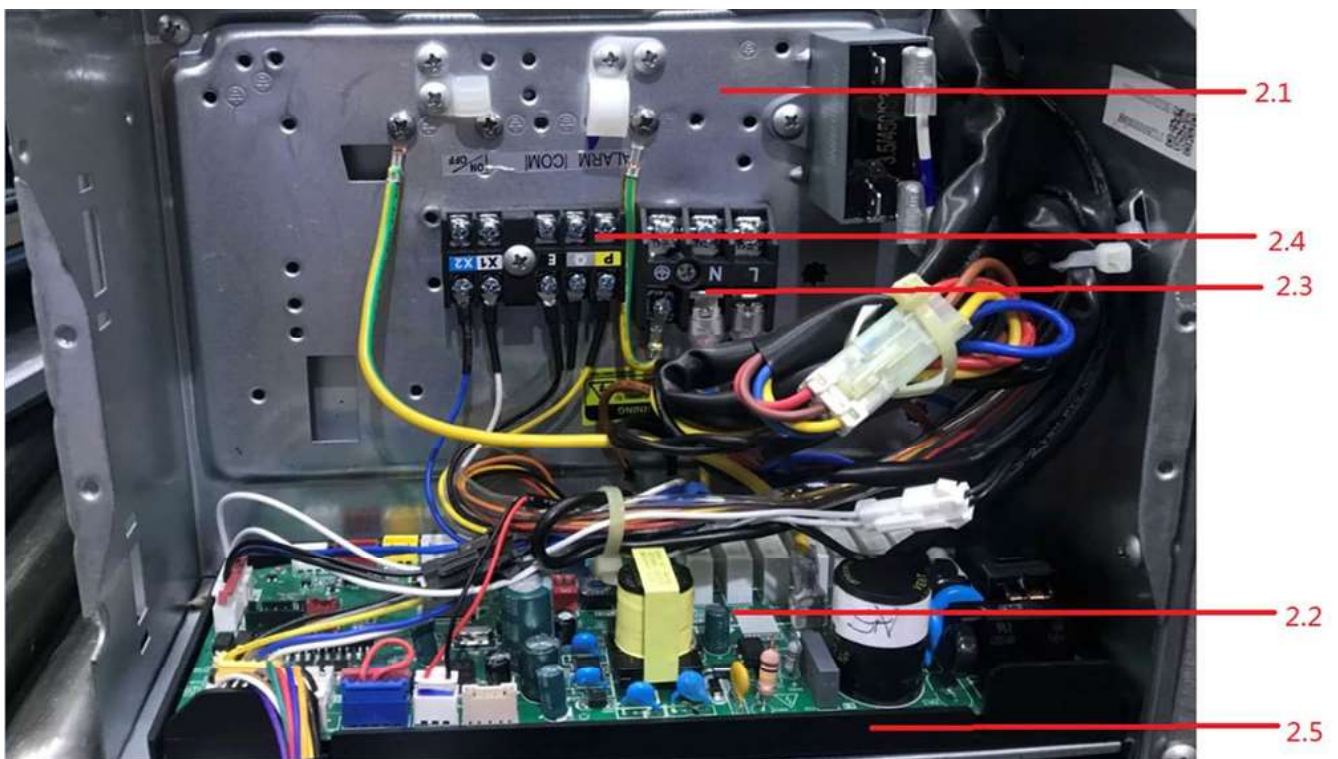
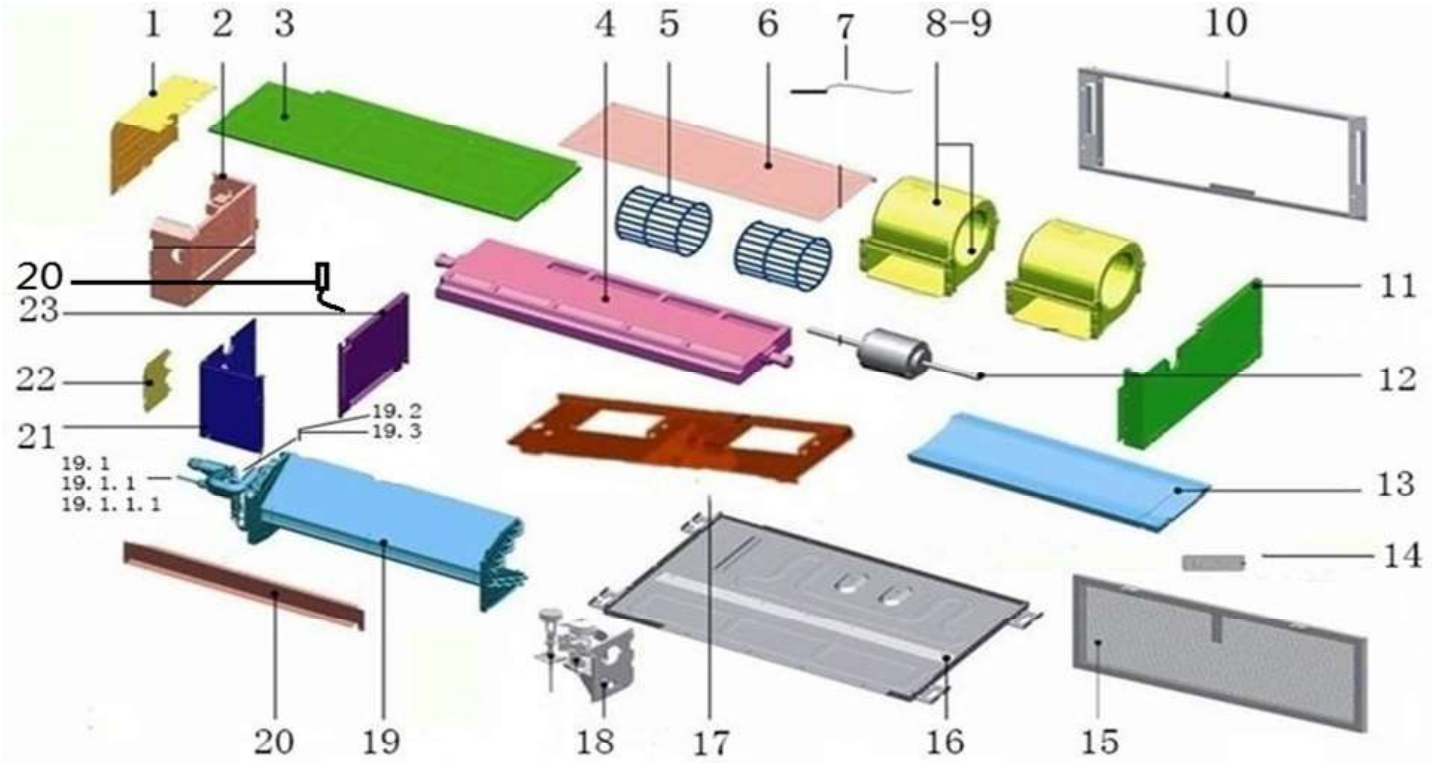

Model: BELP012Q3A-D

No.	Part Name	Part No.
1	Cover of electronic control box subassembly	12223000004387
2	E-part box assembly	17226000004780
2.1	Electronic control box components	12223000003215
2.2	Indoor unit main control board	17126000005254
2.3	Wire joint	17400401000188
2.4	Wire joint	17400401001516
2.5	PCB installation board	12126000002083
3	Top cover assembly	12226000004818
4	Drain pan foam	12823000000024
5	Centrifugal fan	12100103000644
6	Rear cover subassembly	12223000001337
7	Rear cover subassembly	12223000001337
8	top volute	12123000000026
9	volute shell assembly	12126000000061
10	Flange assembly	12223000001510
11	Left clapboard subassembly	12223000001266
12	Single phase asynchronous motor	11002012028044
13	Chassis foam	12823000000021
14	Display board assembly	17223000002836
15	Air filter	12123000000124
16	Base ass	12223000008489
17	Rear beam ass'y	12223000004050
18	Drain pump assembly	17400802000573
19	Evaporator assembly	15826000000452
19.1	Evaporator input pipe assembly	15426000000556
19.1.1	Electronic expansion valve assembly	15426000000557
19.1.1.1	Electronic expansion valve suite	15500213000909
19.2	Evaporator output pipe assembly	15126000002346
19.3	Pipe Temperature Sensor	11201007000070
20	Pipe Temperature Sensor	11201007000030
21	Right clapboard subassembly	12223000001252
22	Pipe clamp board subassembly	12223000008428
23	Right,rear clapboard assembly	12223000001253

Exploded Views and Parts Listing

Indoor Unit Model: BELP015Q3A-D

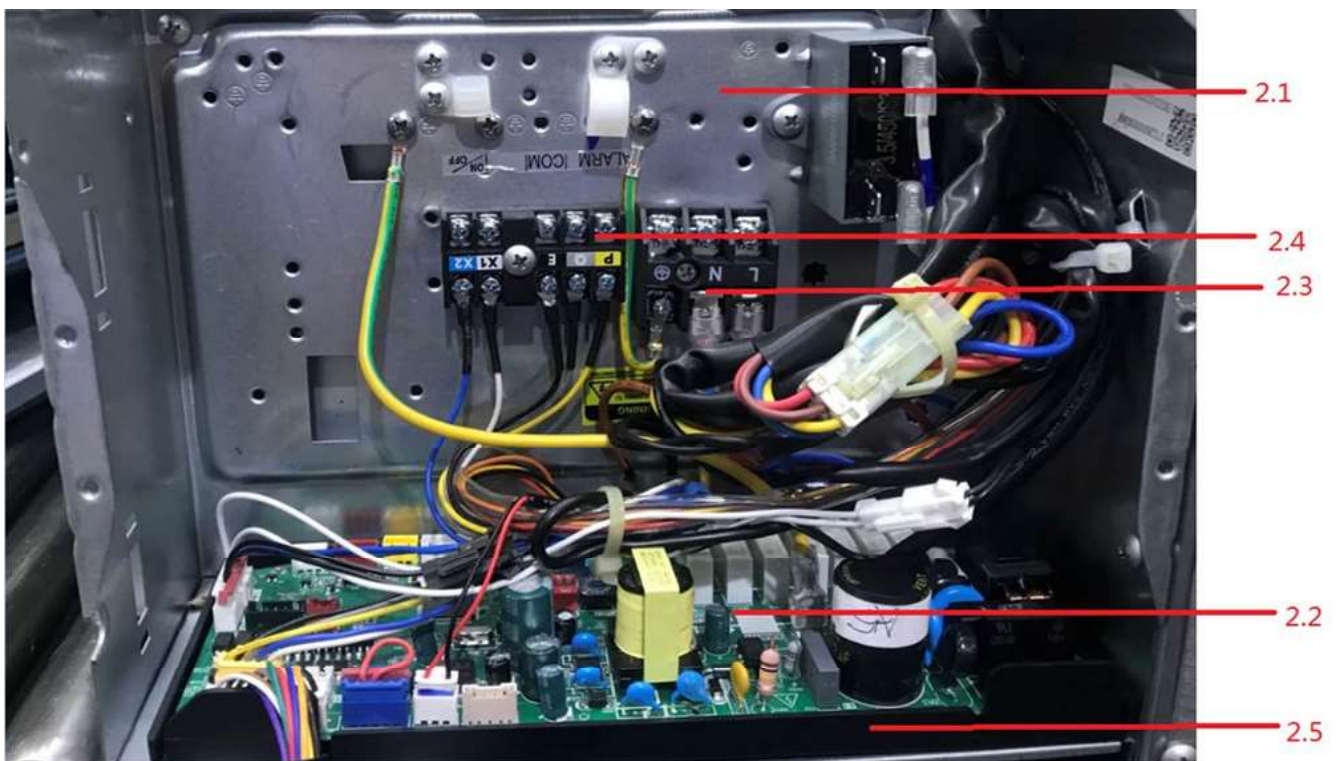
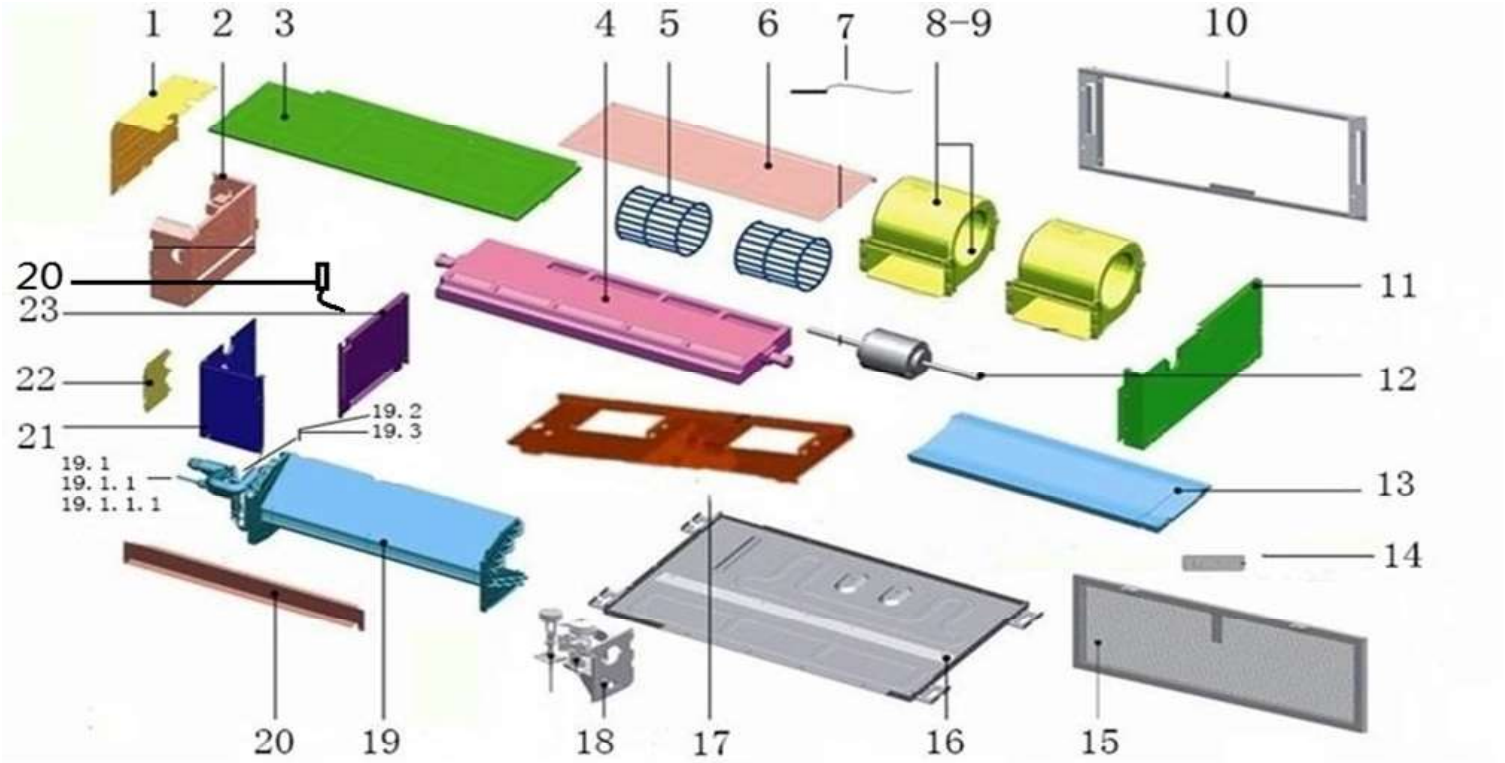

Model: BELP015Q3A-D

No.	Part Name	Part No.
1	Cover of electronic control box subassembly	12223000004387
2	E-part box assembly	17226000004780
2.1	Electronic control box components	12223000003215
2.2	Indoor unit main control board	17126000005254
2.3	Wire joint	17400401000188
2.4	Wire joint	17400401001516
2.5	PCB installation board	12126000002083
3	Top cover assembly	12226000004818
4	Drain pan foam	12823000000024
5	Centrifugal fan	12100103000644
6	Rear cover subassembly	12223000001337
7	Rear cover subassembly	12223000001337
8	top volute	12123000000026
9	volute shell assembly	12126000000061
10	Flange assembly	12223000001510
11	Left clapboard subassembly	12223000001266
12	Single phase asynchronous motor	11002012028044
13	Chassis foam	12823000000021
14	Display board assembly	17223000002836
15	Air filter	12123000000124
16	Base ass	12223000008489
17	Rear beam ass'y	12223000004050
18	Drain pump assembly	17400802000573
19	Evaporator assembly	15826000000452
19.1	Evaporator input pipe assembly	15426000000556
19.1.1	Electronic expansion valve assembly	15426000000557
19.1.1.1	Electronic expansion valve suite	15500213000909
19.2	Evaporator output pipe assembly	15126000002346
19.3	Pipe Temperature Sensor	11201007000070
20	Pipe Temperature Sensor	11201007000030
21	Right clapboard subassembly	12223000001252
22	Pipe clamp board subassembly	12223000008428
23	Right,rear clapboard assembly	12223000001253

Exploded Views and Parts Listing

Indoor Unit Model: BELP019Q3A-D

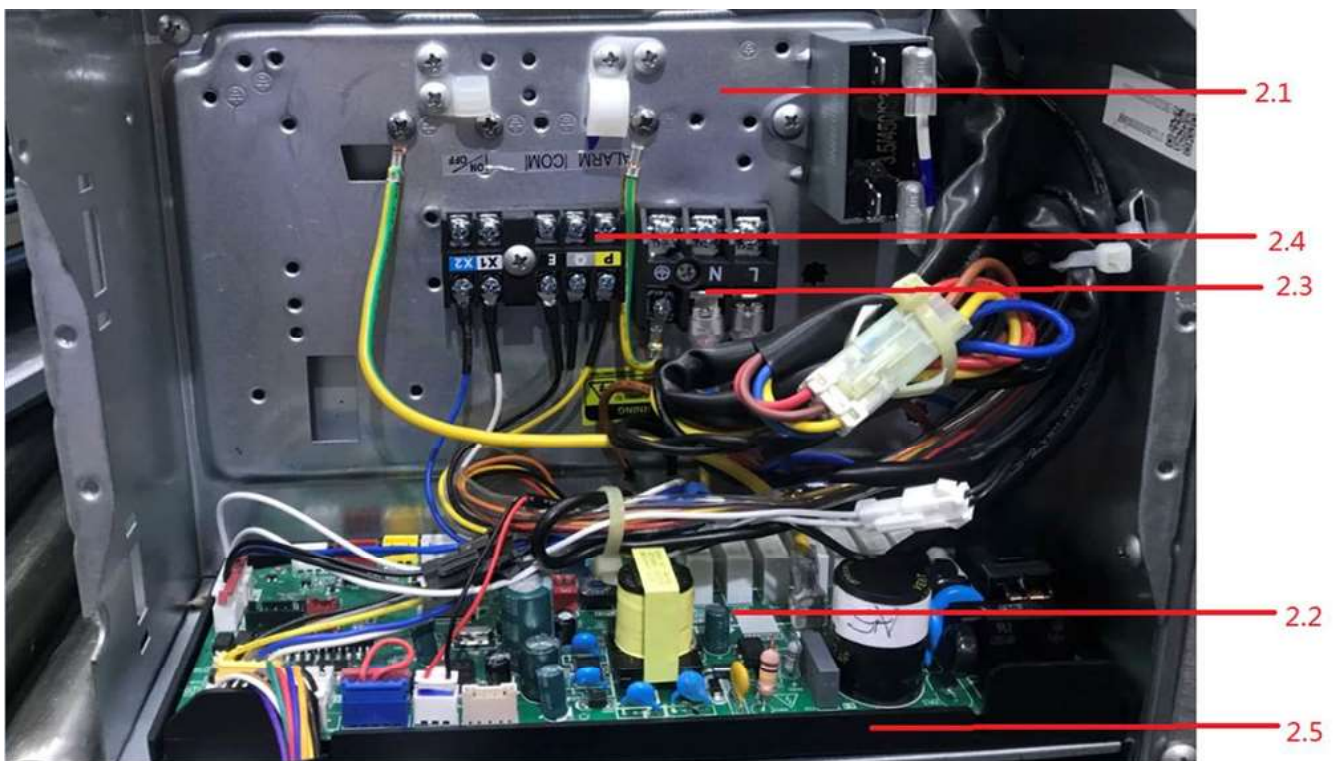
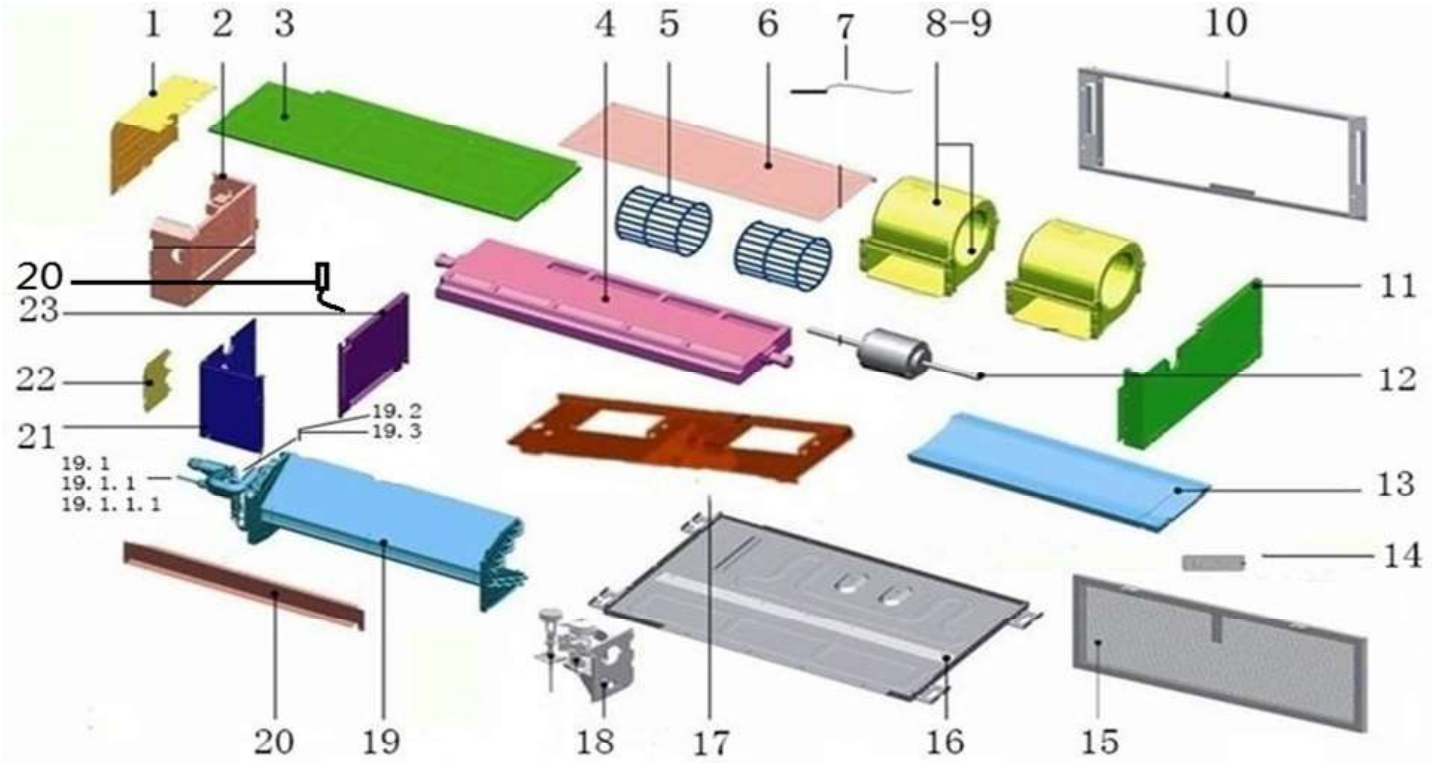

Model: BELP019Q3A-D

No.	Part Name	Part No.
1	Cover of electronic control box subassembly	12223000004387
2	E-part box assembly	17226000004781
2.1	Electronic control box components	12223000003215
2.2	Indoor unit main control board	17126000005254
2.3	Wire joint	17400401000188
2.4	Wire joint	17400401001516
2.5	PCB installation board	12126000002083
3	Top cover subassembly	12223000001349
4	Drain pan foam	12823000000022
5	Centrifugal fan	12100103000685
6	Rear cover subassembly	12223000001354
7	Rear cover subassembly	12223000001354
8	top volute	12123000000027
9	bottom volute	12123000000023
10	Flange assembly	12223000001507
11	Left clapboard subassembly	12223000001266
12	Single phase asynchronous motor	11002012028204
13	Chassis foam	12823000000020
14	Display board assembly	17223000002836
15	Air filter	12123000000131
16	Chassis ass	12223000008488
17	Front beam assembly	12223000008490
18	Drain pump assembly	17400802000573
19	Evaporator assembly	15826000000933
19.1	Evaporator input pipe assembly	15426000000354
19.2	Evaporator outlet pipe subassembly	15126000001526
19.3	Pipe Temperature Sensor	11201007000070
20	Pipe Temperature Sensor	11201007000030
21	Right clapboard subassembly	12223000001252
22	Pipe clamp board subassembly	12223000008428
23	Right, rear clapboard assembly	12223000001253

Exploded Views and Parts Listing

Indoor Unit Model: BEMP024Q3A-D

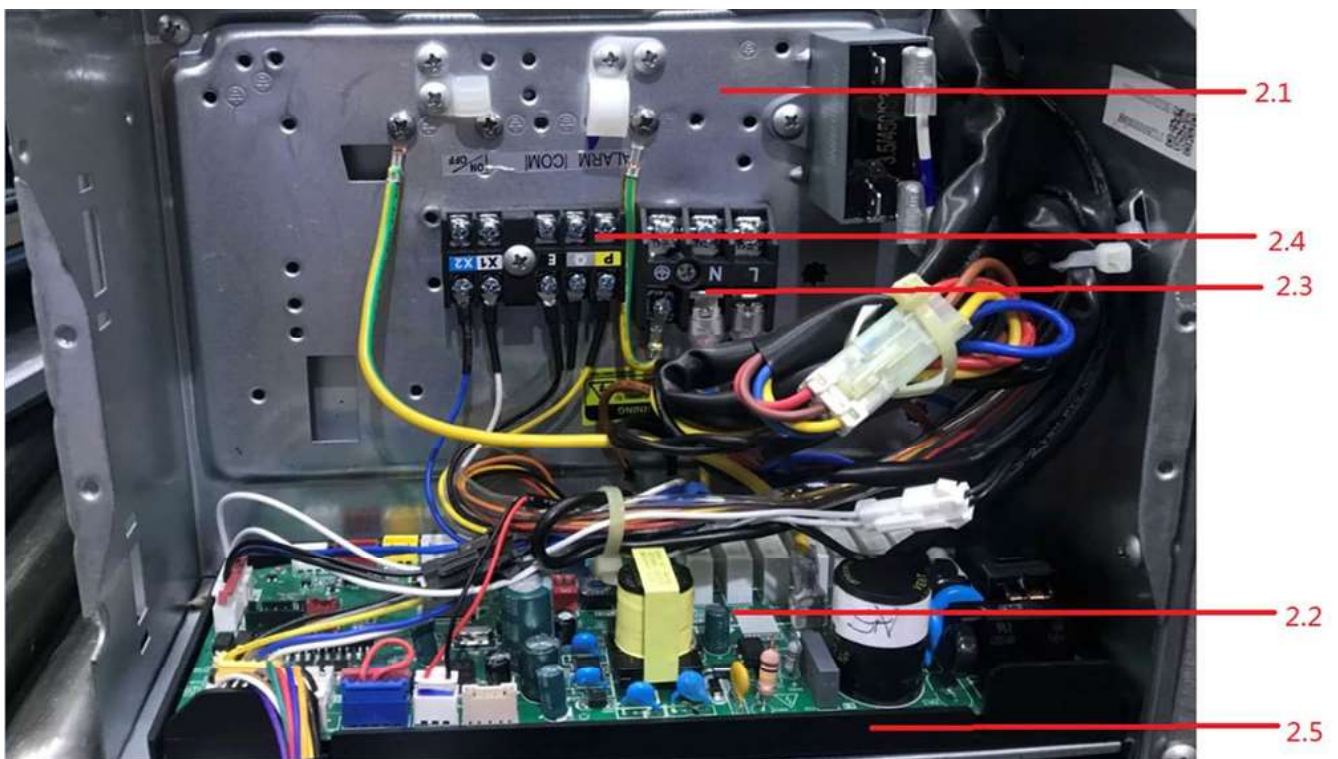
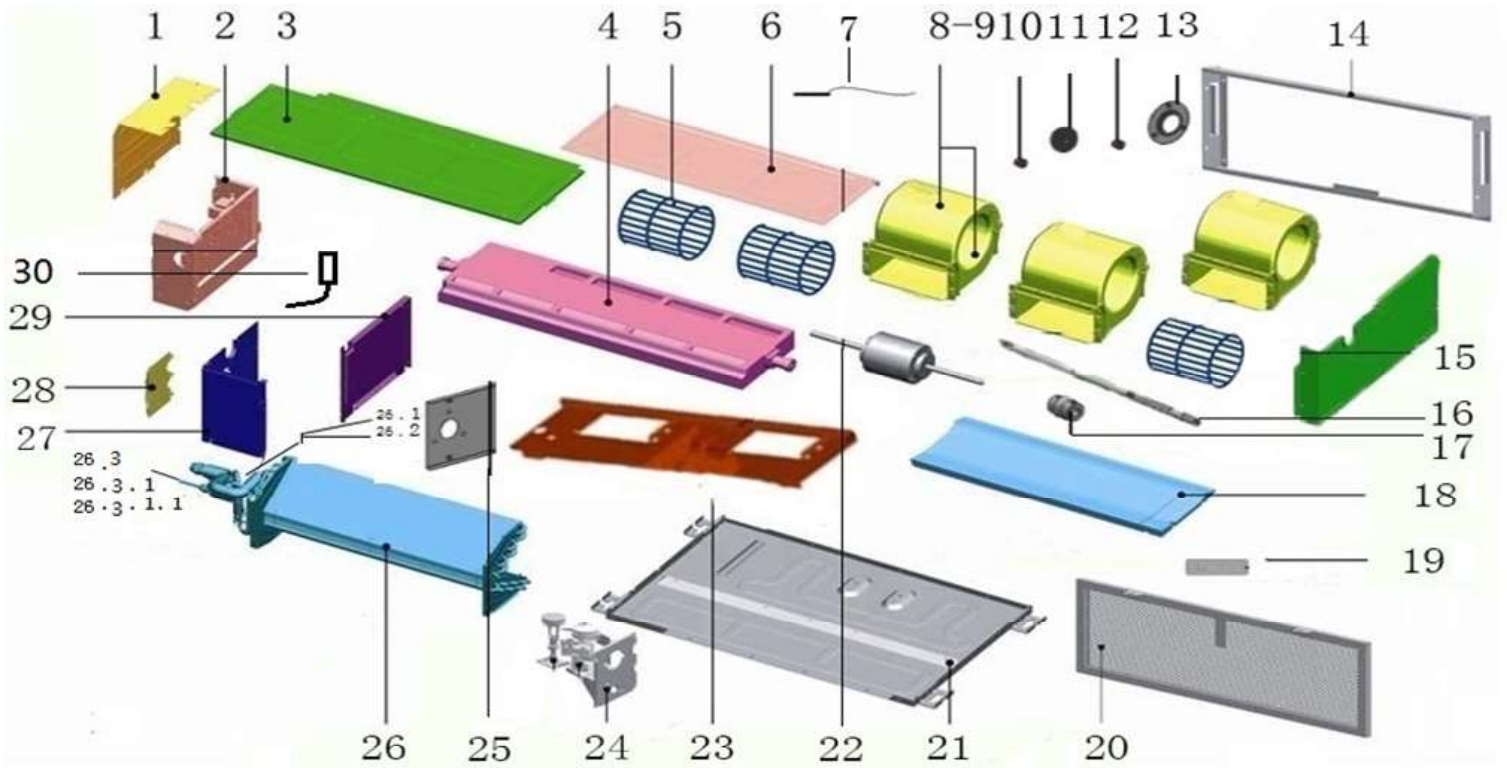

Model: BEMP024Q3A-D

No.	Part Name	Part No.
1	Cover of electronic control box subassembly	12223000004387
2	E-part box assembly	17226000004781
2.1	Electronic control box components	12223000003215
2.2	Indoor unit main control board	17126000005254
2.3	Wire joint	17400401000188
2.4	Wire joint	17400401001516
2.5	PCB installation board	12126000002083
3	Top cover subassembly	12223000001351
4	water butt dish foam	12826000000032
5	Centrifugal fan	12100103000685
6	Rear cover subassembly	12223000001362
7	Room Temperature Sensor	11201007000063
8	top volute	12123000000027
9	bottom volute	12123000000023
10	Bearing	12122000007617
11	Rubber pad	12600401000652
12	bearing block	12623000000054
13	Pipe clamp board	12223000004043
14	Flange assembly	12223000003328
15	Left clapboard subassembly	12223000001266
16	Connecting shaft	12900601000009
17	Coupling	12918000001320
18	Chassis foam	12826000000031
19	Display board assembly	17223000002836
20	Filter	12100204001188
21	chassis ass	12223000008487
22	Single phase asynchronous motor	11002012028205
23	Front beam assembly	12223000008491
24	Drain pump assembly	17400802000573
25	Support Plate	12223000006288
26	Evaporator assembly	15826000000932
26.1	Pipe Temperature Sensor	11201007000070
26.2	Evaporator outlet pipe subassembly	15126000001526
26.3	Evaporator input pipe assembly	15426000000354
26.3.1	Filter subassembly	15426000000324
26.3.1.1	Electronic expansion valve suite	15500213000909
27	Right clapboard subassembly	12223000001252
28	Pipe clamp board subassembly	12223000008428
29	Right, rear clapboard assembly	12223000001253
30	Pipe Temperature Sensor	11201007000030

Exploded Views and Parts Listing

Indoor Unit Model: BEMP027Q3A-D

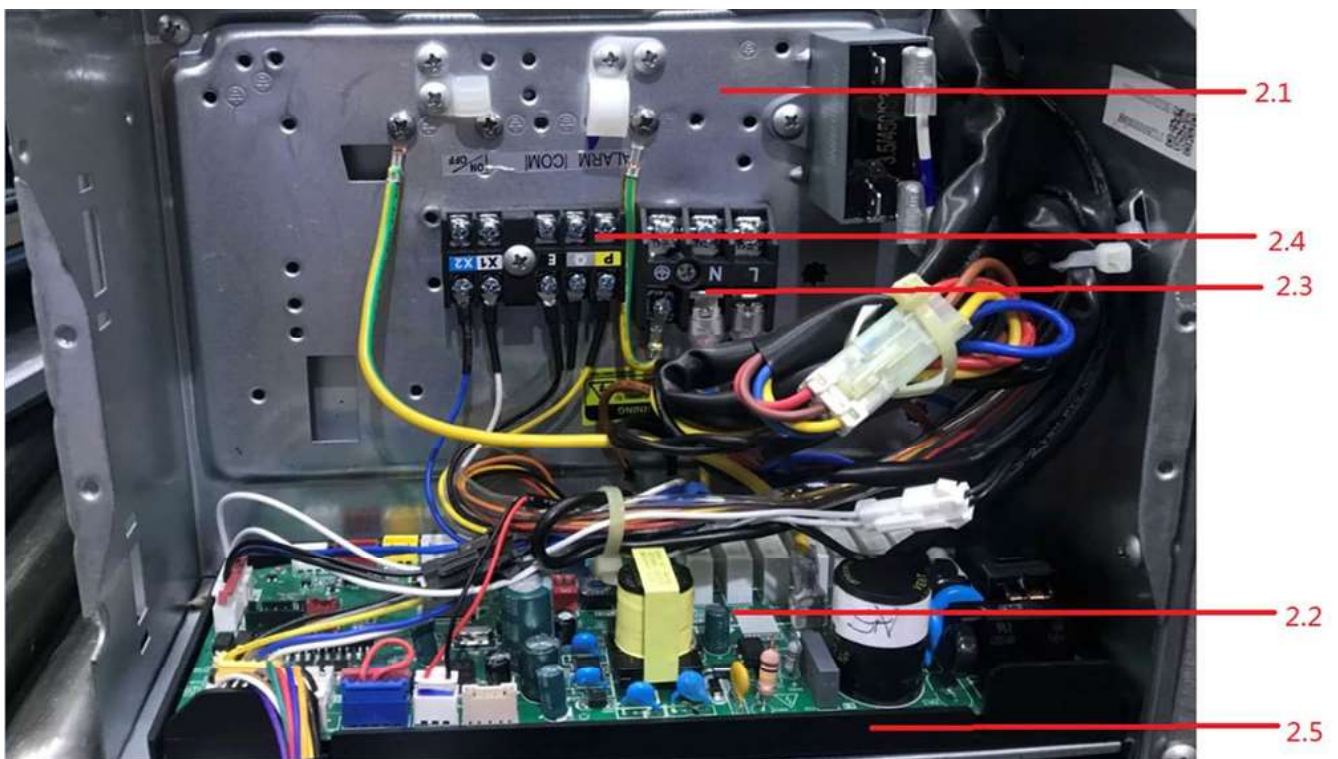
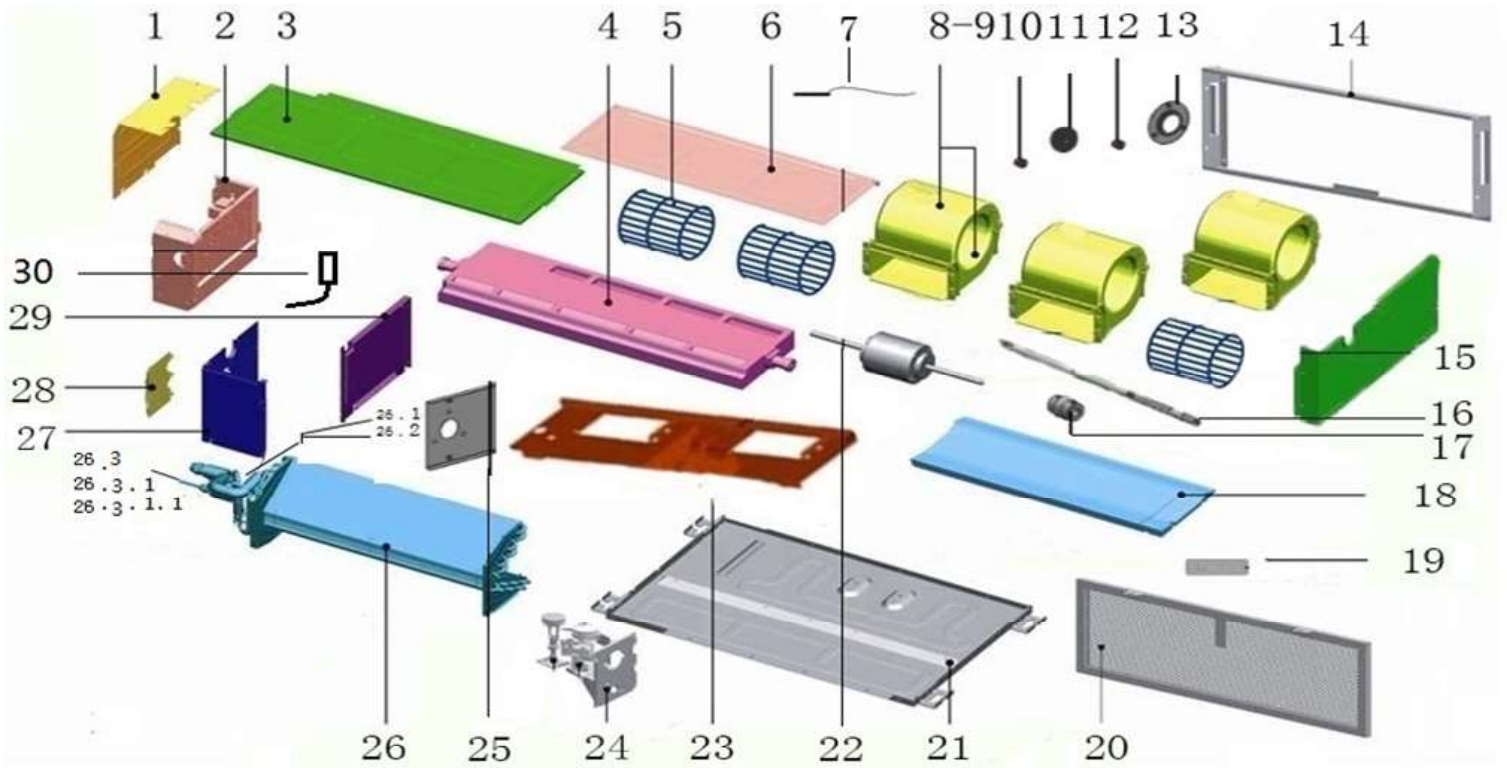

Model: BEMP027Q3A-D

No.	Part Name	Part No.
1	Top cover subassembly	12223000000201
2	Water collector assembly	12826200000027
3	centrifuge fan	12100103000079
4	Single phase asynchronous motor	11002012001189
5	top volute	12123000000024
6	bottom volute	12123000000022
7	Left clapboard subassembly	12223000001290
8	Evaporator assembly	15823000005646
8.1	Evaporator output pipe assembly	15423000005323
8.2	Evaporator input pipe assembly	15423000005324
8.2.1	Electronic expansion valve assy	15426000000334
8.4	Pipe Temperature Sensor	11201007001561
8.5	Pipe Temperature Sensor	11201007000136
9	Chassis assembly	12223000001471
10	Rubber tube	12623000000003
11	Water pump	17400802000174
12	Water level switch	17400511000026
13	Drain pump bracket assembly	12226000000713
14	Cover of water testing hole	12123000000043
15	Drain pipe	12100510000021
16	Right clapboard assembly	12223000001294
17	Supporting board assembly, evaporator	12226000004360
18	Pipe clamp board subassembly	12223000000524
19	Electric control box cover assembly	12223000004867
20	Motor bracket assembly	12226000000367
21	Fan motor fixing board	12223000000533
22	E-part box assembly	17226000004782
22.1	Display board assembly	17223000002836
22.2	Indoor unit main control board	17126000005254
22.4	Wire joint	17400401000156
22.6	Electronic control box	12226000000385
22.7	Wire joint	17400401001516
23	Right clapboard strengthen board	12223000000110
24	Air filter	12100204000536
25	Beam assembly	12223000001568
26	Rear cover subassembly	12223000001658
27	Right clapboard	12223000000267
28	Right clapboard subassembly	12223000000456
29	Room Temperature Sensor	11201007000063

Exploded Views and Parts Listing

Indoor Unit Model: BEMP035Q3A-D

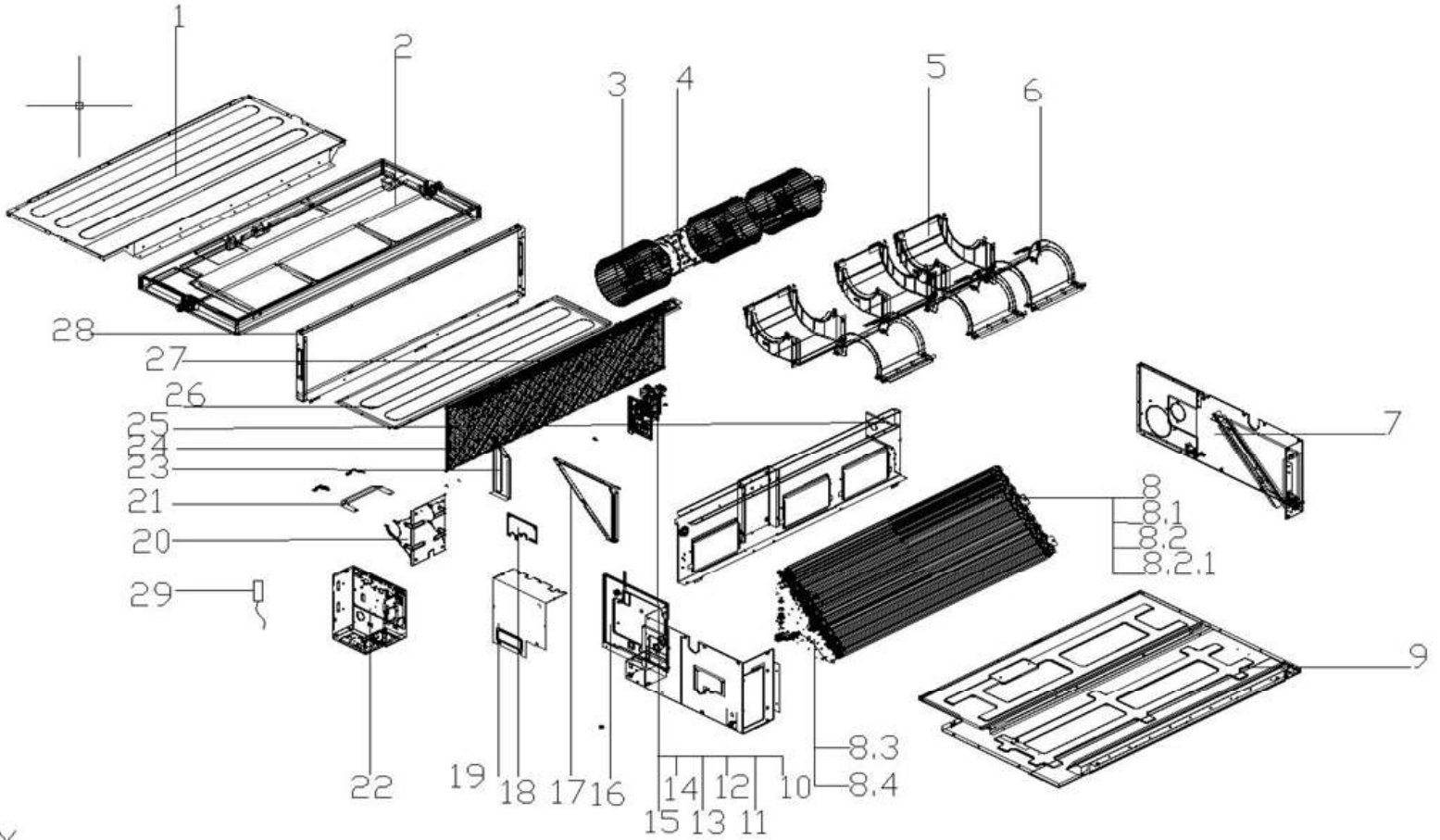

X

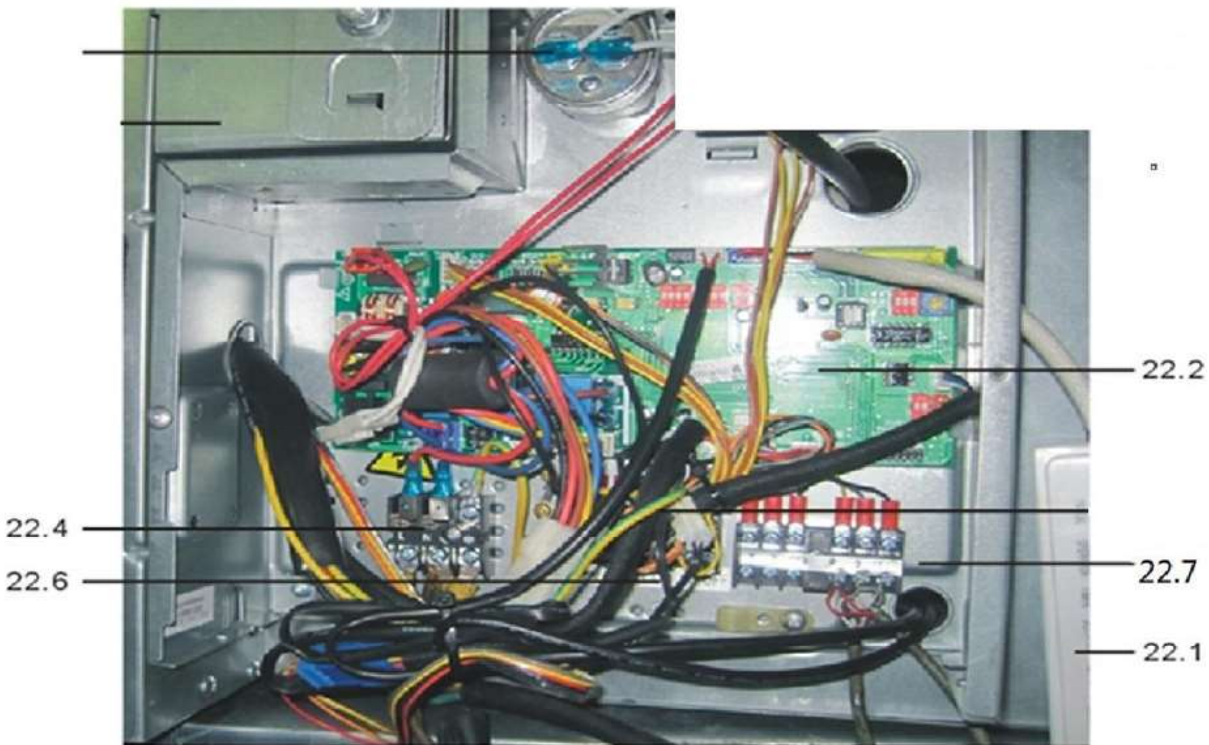

Model: BEMP035Q3A-D

No.	Part Name	Part No.
1	Top cover subassembly	12223000000201
2	Water collector assembly	12826200000027
3	centrifuge fan	12100103000079
4	Single phase asynchronous motor	11002012001189
5	top volute	12123000000024
6	bottom volute	12123000000022
7	Left clapboard subassembly	12223000001290
8	Evaporator assembly	15823000005646
8.1	Evaporator output pipe assembly	15423000005323
8.2	Evaporator input pipe assembly	15423000005324
8.2.1	Electronic expansion valve assy	15426000000334
8.4	Pipe Temperature Sensor	11201007001561
8.5	Pipe Temperature Sensor	11201007000136
9	Chassis assembly	12223000001471
10	Rubber tube	12623000000003
11	Water pump	17400802000174
12	Water level switch	17400511000026
13	Drain pump bracket assembly	12226000000713
14	Cover of water testing hole	12123000000043
15	Drain pipe	12100510000021
16	Right clapboard assembly	12223000001294
17	Supporting board assembly, evaporator	12226000004360
18	Pipe clamp board subassembly	12223000000524
19	Electric control box cover assembly	12223000004867
20	Motor bracket assembly	12226000000367
21	Fan motor fixing board	12223000000533
22	E-part box assembly	17226000004782
22.1	Display board assembly	17223000002836
22.2	Indoor unit main control board	17126000005254
22.4	Wire joint	17400401000156
22.6	Electronic control box	12226000000385
22.7	Wire joint	17400401001516
23	Right clapboard strengthen board	12223000000110
24	Air filter	12100204000536
25	Beam assembly	12223000001568
26	Rear cover subassembly	12223000001658
27	Right clapboard	12223000000267
28	Right clapboard subassembly	12223000000456
29	Room Temperature Sensor	11201007000063

Exploded Views and Parts Listing

Indoor Unit Model: BEMP038Q3A-D

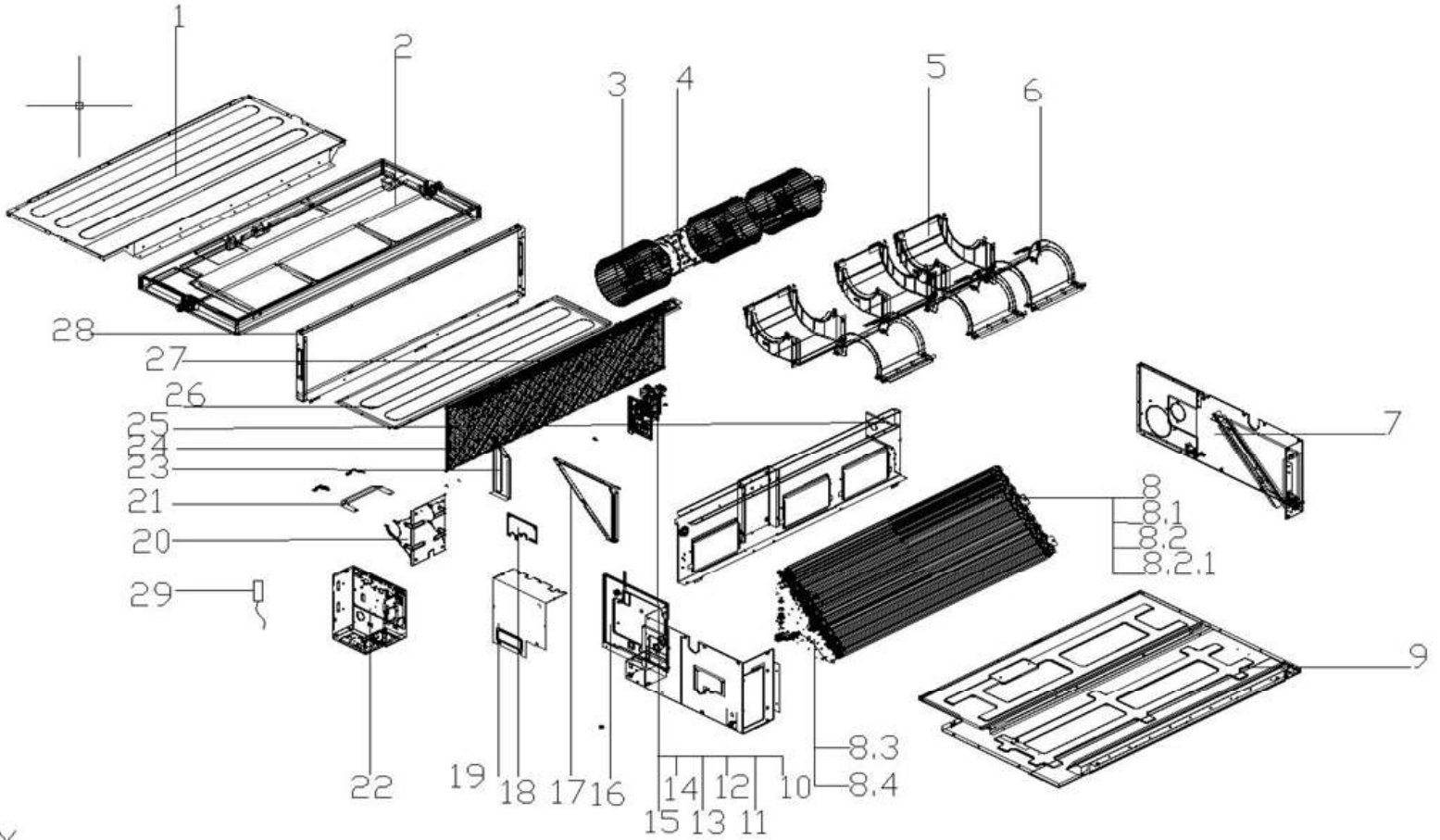

X

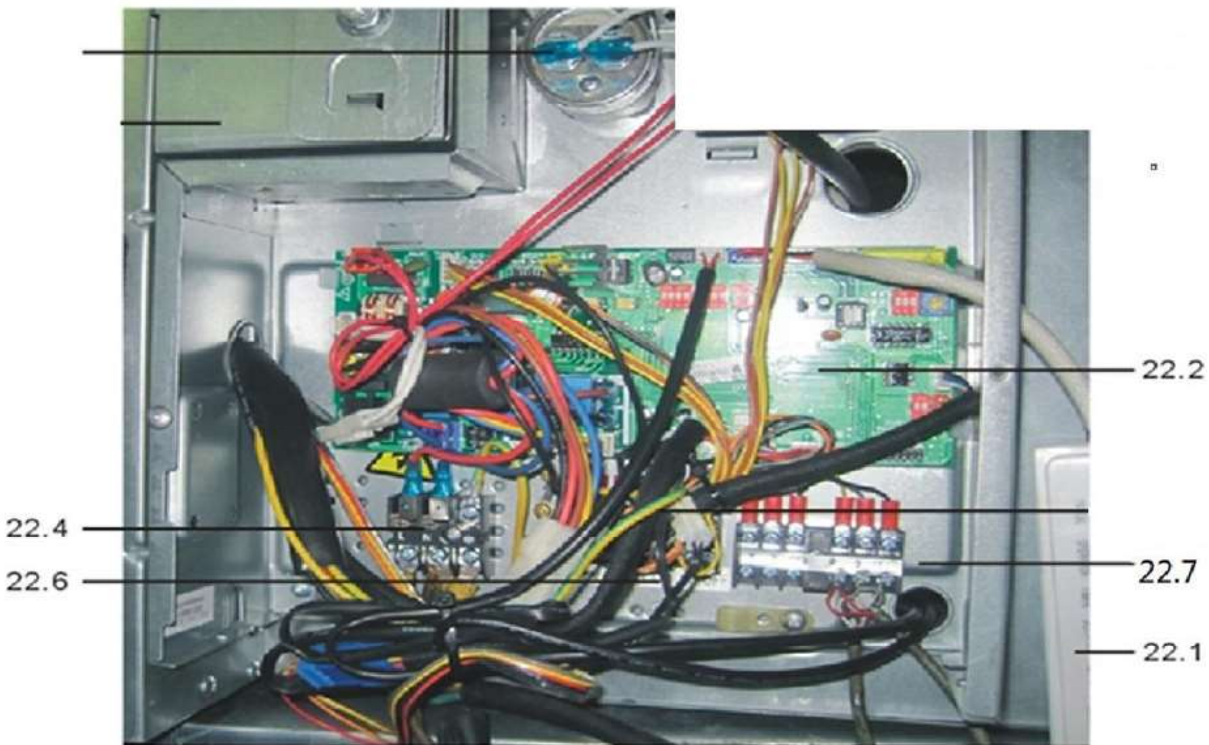

Model: BEMP038Q3A-D

No.	Part Name	Part No.
1	Top cover subassembly	12223000000201
2	Water collector assembly	12826200000027
3	centrifuge fan	12100103000079
4	Asynchronous motor	11002012000470
5	top volute	12123000000024
6	bottom volute	12123000000022
7	Left clapboard subassembly	12223000001290
8	Evaporator assembly	15823000005646
8.1	Evaporator output pipe assembly	15423000005323
8.2	Evaporator input pipe assembly	15423000005324
8.2.1	Electronic expansion valve assy	15426000000334
8.4	Pipe Temperature Sensor	11201007001561
8.5	Pipe Temperature Sensor	11201007000136
9	Chassis assembly	12223000001471
10	Rubber tube	12623000000003
11	Drain pump	17400802000167
12	Water Level Switch	17400511000036
13	Bracket Subassembly of Water Drain Pump(RoHS)	12223000001694
14	Cover of water testing hole	12123000000043
15	Drain pipe	12100510000021
16	Right clapboard assembly	12223000001294
17	Supporting board assembly, evaporator	12226000004360
18	Pipe clamp board subassembly	12223000000524
19	Electric control box cover assembly	12223000004867
20	Motor bracket assembly	12226000000367
21	Fan motor fixing board	12223000000533
22	E-part box assembly	17226000004782
22.1	Display board assembly	17223000002836
22.2	Indoor unit main control board	17126000005254
22.4	Wire joint	17400401000156
22.6	Electronic control box	12226000000385
22.7	Wire joint	17400401001516
23	Right clapboard strengthen board	12223000000110
24	Air filter	12100204000536
25	Beam assembly	12226000000437
26	Rear cover subassembly	12223000001658
27	Right clapboard	12223000000267
28	Right clapboard subassembly	12223000000456
29	Room Temperature Sensor	11201007000063

Exploded Views and Parts Listing

Indoor Unit Model: BEMP048Q3A-D

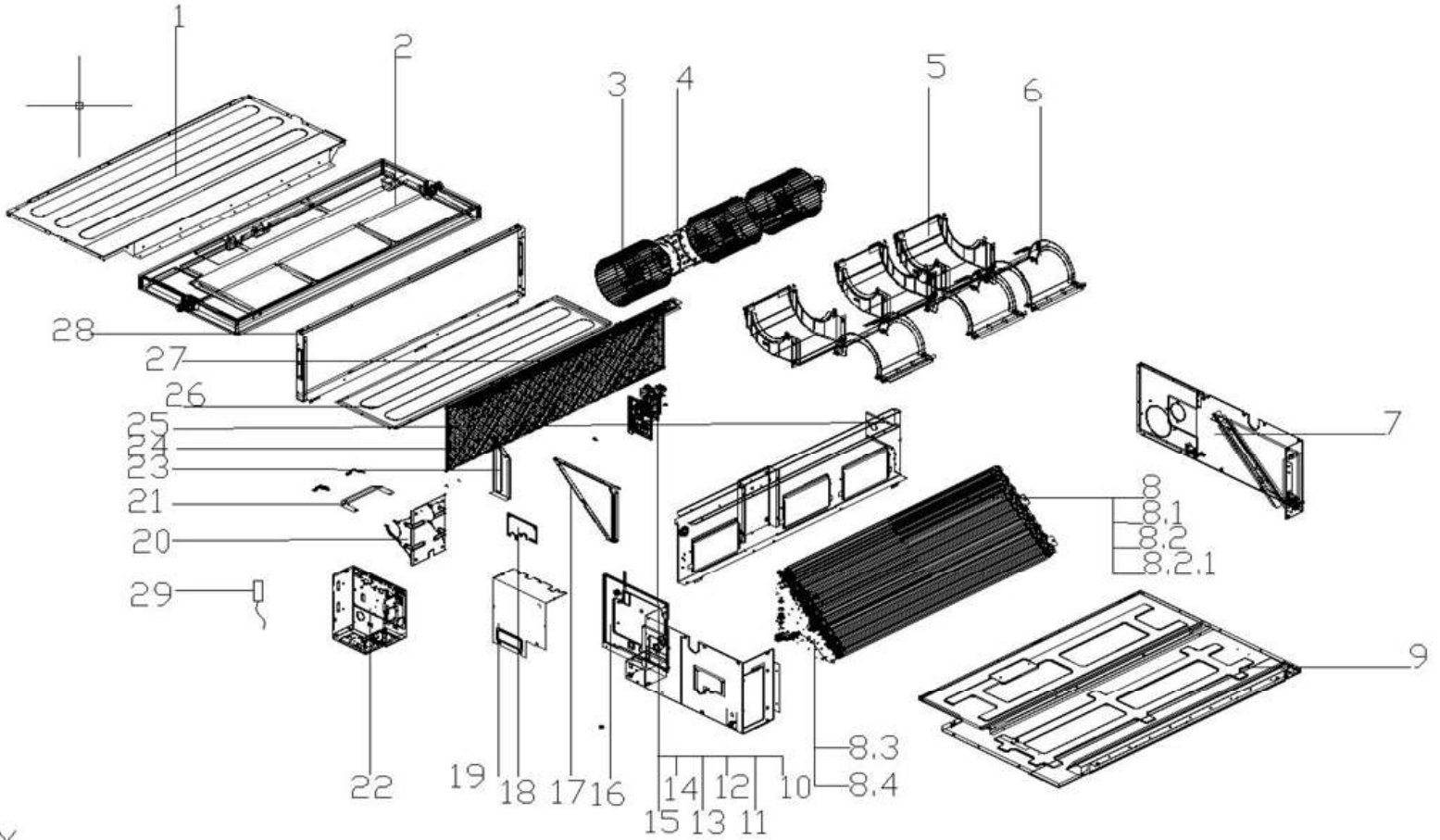

X

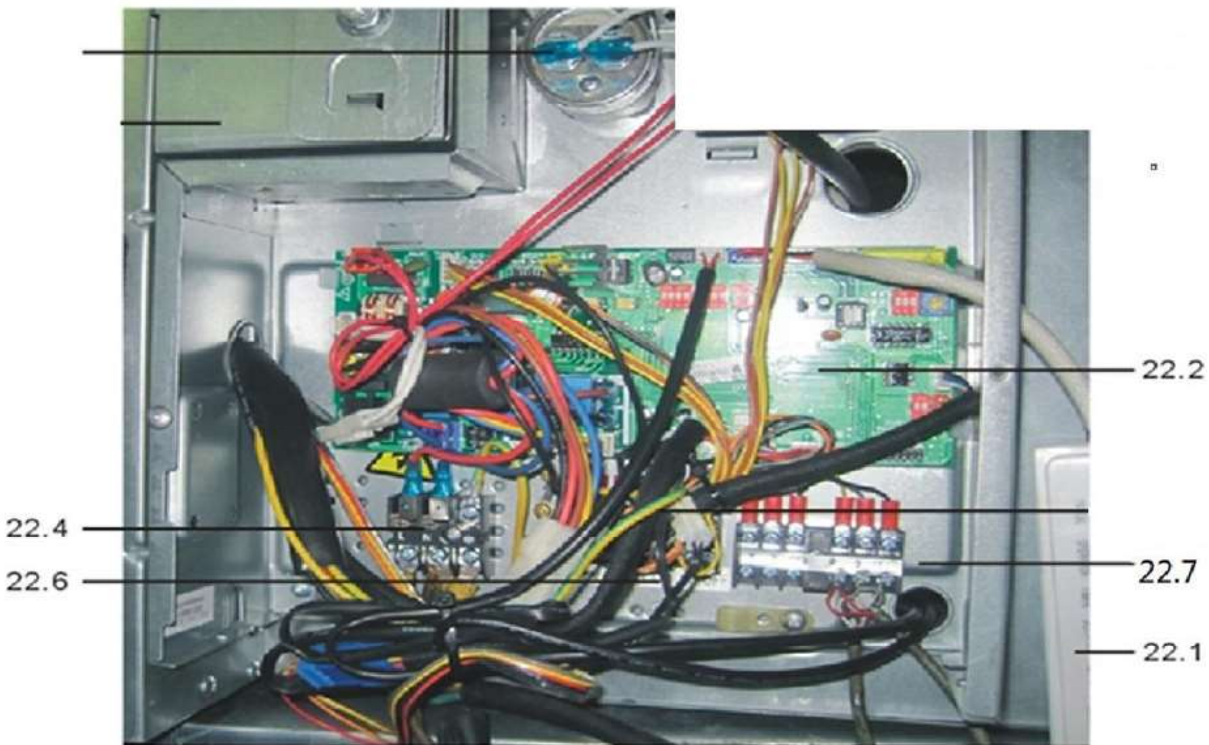

Model: BEMP048Q3A-D

No.	Part Name	Part No.
1	Top cover subassembly	12223000000198
2	drain tray ass'y	12826200000047
3	centrifuge fan	12100103000079
4	Fan motor	11002012001211
5	top volute	12123000000024
6	bottom volute	12123000000022
7	Left clapboard subassembly	12223000001249
8	Evaporator ass'y	158230000005648
8.1	Evaporator output pipe assembly	154260000002317
8.2	Evaporator input pipe assembly	154260000002318
8.2.1	Expansion valve assembly	154260000000326
8.5	Pipe Temperature Sensor	11201007000136
10	Rubber tube	126230000000003
11	Drain pump	17400802000167
12	Water Level Switch	17400511000036
13	Bracket Subassembly of Water Drain Pump(RoHS)	12223000001694
14	Cover of water testing hole	121230000000043
15	Drain pipe	121005100000021
16	Right clapboard assembly	12223000001291
17	Supporting board assembly, evaporator	12226000004359
18	Pipe clamp board subassembly	122230000000524
19	Electric control box cover assembly	12223000004867
20	Motor bracket assembly	122260000000367
21	Fan motor fixing board	122230000000533
22	E-part box assembly	17226000004782
22.1	Display board assembly	172230000002836
22.2	Indoor unit main control board	171260000005254
22.4	Wire joint	17400401000156
22.6	Electronic control box	122260000000385
22.7	Wire joint	17400401001516
23	Right clapboard strengthen board	12223000000112
24	Air filter	121002040000698
25	Beam assembly	12223000001567
26	Rear cover subassembly	12223000001655
27	Rear beam assembly	12223000001566
28	Right clapboard subassembly	12223000000457
29	Room Temperature Sensor	112010070000063

Exploded Views and Parts Listing

Indoor Unit Model: BEHP060Q3A-D

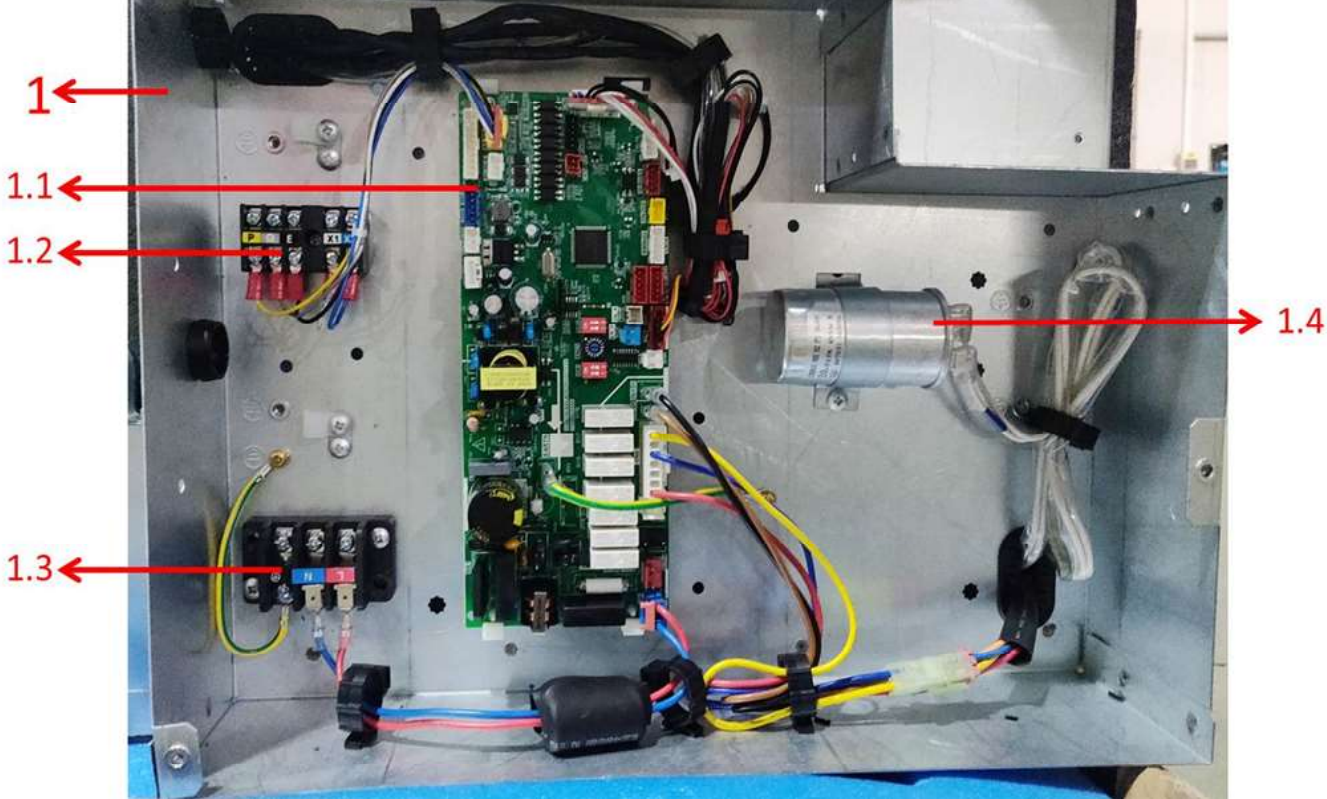
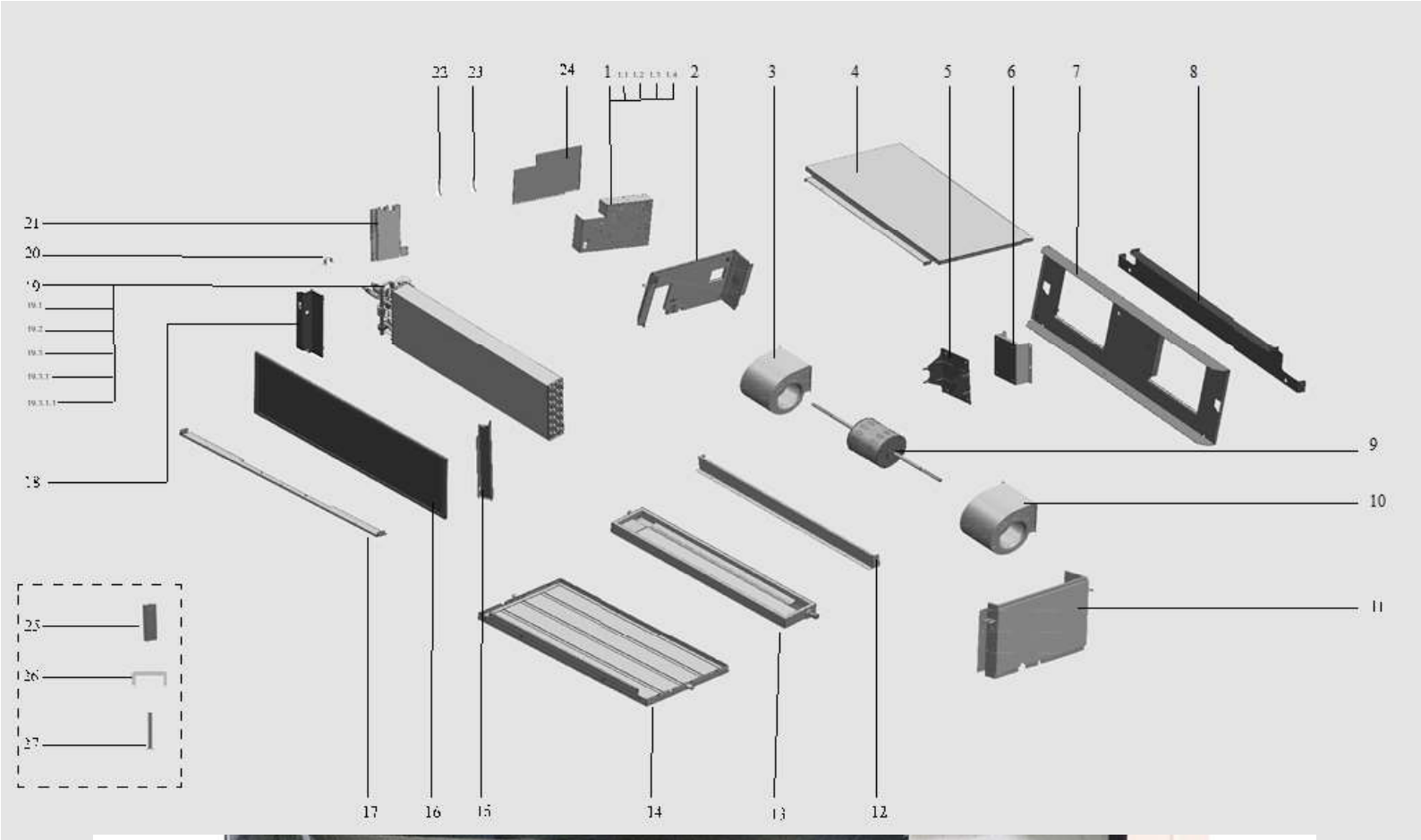

Model: BEHP060Q3A-D

No.	Part Name	Part No.
1	E-part box assembly	17226000004804
1.1	Indoor unit main control board	17126000005369
1.2	Wire joint	17400401001516
1.3	Wire joint	17400401000201
1.4	Capacitor	17400103000151
2	Side board ass'y	12226000003496
3	Wind turbine parts	12200101000037
3	Wind turbine parts	12200101000014
4	cover board,top	12226000000215
5	Fan motor support	12223000000565
6	bracket assembly,motor	12223000000875
7	bracket assembly fan	12223000000877
8	Front panel assembly	12223000000145
9	Single phase asynchronous motor	11002012001040
11	Left clapboard ass'y	12223000001065
12	beam ass'y	12226000000440
13	Drain tray	12822500000131
14	chassis ass'y	12226000000141
15	evaporator left support	12223000000310
16	air fresh filter	12100204A00159
17	Rear clapboard	12223000000160
18	Evaporator right support board subassembly	12223000000292
19	Evaporator ass'y	15826000000040
19.1	Evaporator output pipe assembly	15426000001199
19.2	Pipe Temperature Sensor	11201007000136
19.3	Inlet pipe ass'y	15426000000350
19.3.1	Electronic expansion valve ass'y	15426000000325
19.3.1.1	Electronic expansion valve suite	15500213000911
20	Pipe fixing clamp	12223000001610
21	cover plate	12226000000292
22	Room Temperature Sensor	11201007000025
23	Pipe Temperature Sensor	11201007000030
24	E-Part box cover	12226000000009
25	VRF IDU display box assembly	17226000003959
26	Fan motor fixing board	12223000001006
27	Supporting board	12223000000020